

San áirneamh tá sonraíocht Shuirbhéireacht Orlándaí Éireann arna aistriú go dtí físeán OSI Uimh. 2010/18CCMA/Comhairle Contae na Gaillimhe. Sáráilom aistriú go dtí neamháráilthe cóipeacht Shuirbhéireacht Orlándaí Éireann agus Rialtas na hÉireann. © Suirbhéireacht Orlándaí Éireann, 2010.

© Suirbhéireacht Orlándaí Éireann. Gach ceart ar chosaint. Uimhir cheadainis 2010/18CCMA/Comhairle Contae na Gaillimhe.

Includes Ordnance Survey Ireland data reproduced under OSI Licence number 2010/18CCMA/Galway County Council. Unauthorised reproduction infringes Ordnance Survey Ireland and Government of Ireland copyright. © Ordnance Survey Ireland, 2010.

© Ordnance Survey Ireland. All rights reserved. Licence number 2010/18CCMA/Galway County Council.

Clients

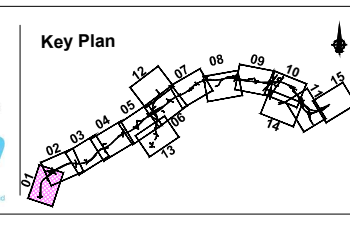

Consultant

Corporate House  
City East Business Park  
Ballybrit, Galway, Ireland.

Tel +353 (0)91 460675  
www.N6GalwayCity.ie  
www.arup.ie

Job Title  
**N6 Galway City Ring Road**

Scale  
1:5000 @ A3

Date  
September 2018

Issue	Date	By	Chkd	Appd
I3	28/09/2018	KJ	MH	EMC
I2	29/09/2017	AG	MH	EMC
I1	23/06/2017	AG	MH	EMC

Drawing Title  
**Proposed Road Development Plan Layout and Drainage Network**  
Sheet 1 of 15

Drawing Status  
**For Information**

Job No  
**233985**

Drawing No  
**Figure 2.1**

Issue  
**I3**



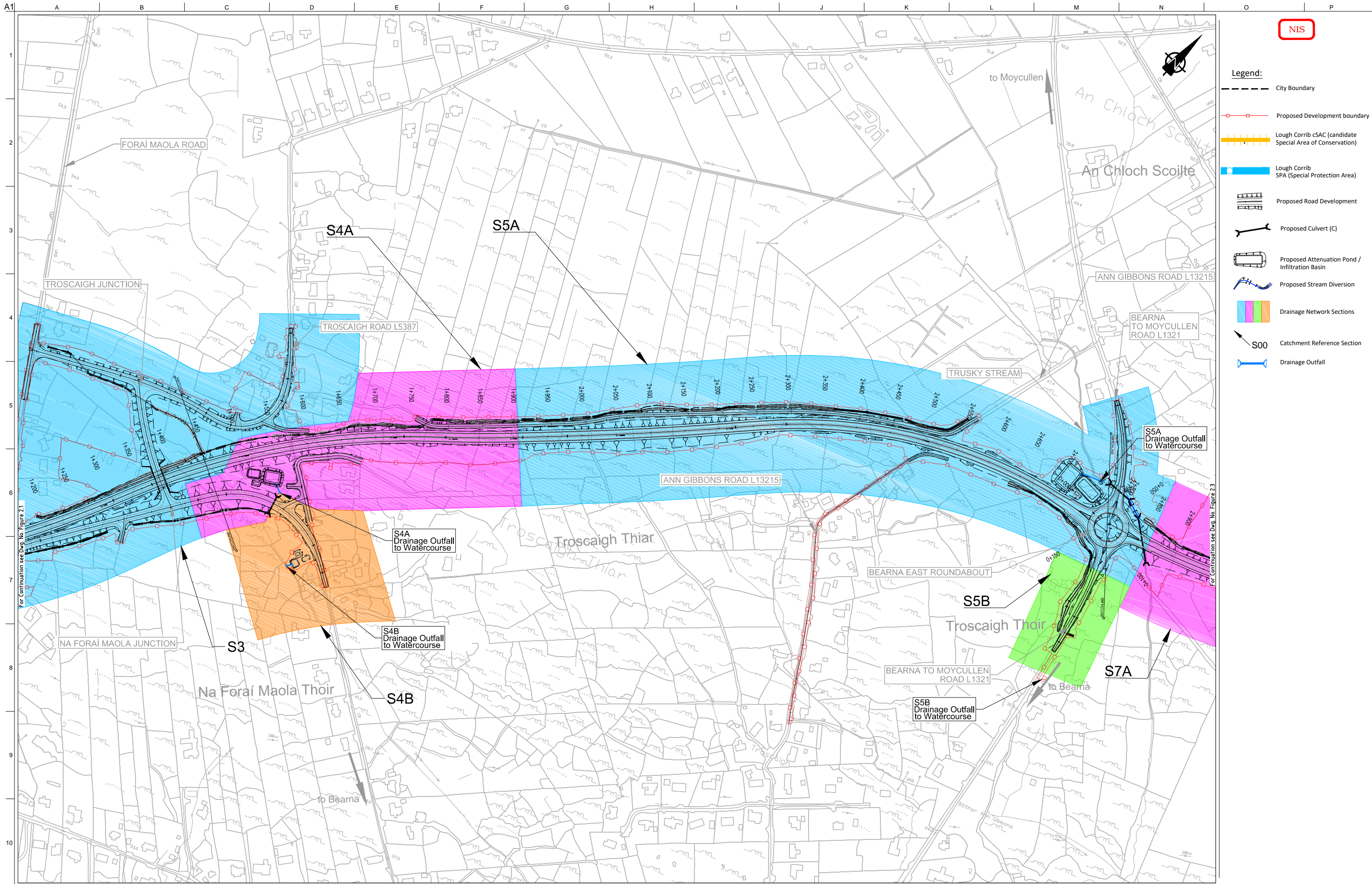

San áireamh tá sonraíocht Shuirbhíreacht Orlándaí Éireann arna aistriú go dtí físeán OSI Umh. 2010/18CCMA/Comhairle Contae na Gaillimhe. Sáráilom aistriú go dtí na h-áireamh. © Suirbhíreacht Orlándaí Éireann, 2010.

© Suirbhíreacht Orlándaí Éireann. Gach ceart ar chosaint. Umhír cheadúnas 2010/18CCMA/Comhairle Contae na Gaillimhe.

Includes Ordnance Survey Ireland data reproduced under OSI Licence number 2010/18CCMA/Galway County Council. Unauthorised reproduction infringes Ordnance Survey Ireland and Government of Ireland copyright. © Ordnance Survey Ireland, 2010.

© Ordnance Survey Ireland. All rights reserved. Licence number 2010/18CCMA/Galway County Council.

Clients

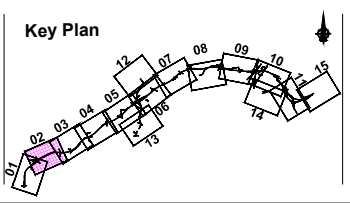

Consultant

Corporate House  
City East Business Park  
Ballybrit, Galway, Ireland.

Tel +353 (0)91 460675  
www.N6GalwayCity.ie  
www.arup.ie

Job Title  
**N6 Galway City Ring Road**

Scale  
1:5000 @ A3

Date:  
September 2018

Issue	Date	By	Chkd	Appd
I3	28/09/2018	KJ	MH	EMC
I2	29/09/2017	AG	MH	EMC
I1	23/06/2017	AG	MH	EMC

Drawing Title  
**Proposed Road Development Plan Layout and Drainage Network References**  
Sheet 2 of 15

Drawing Status  
**For Information**

Job No  
**233985**

Drawing No  
**Figure 2.2**

Issue  
**13**



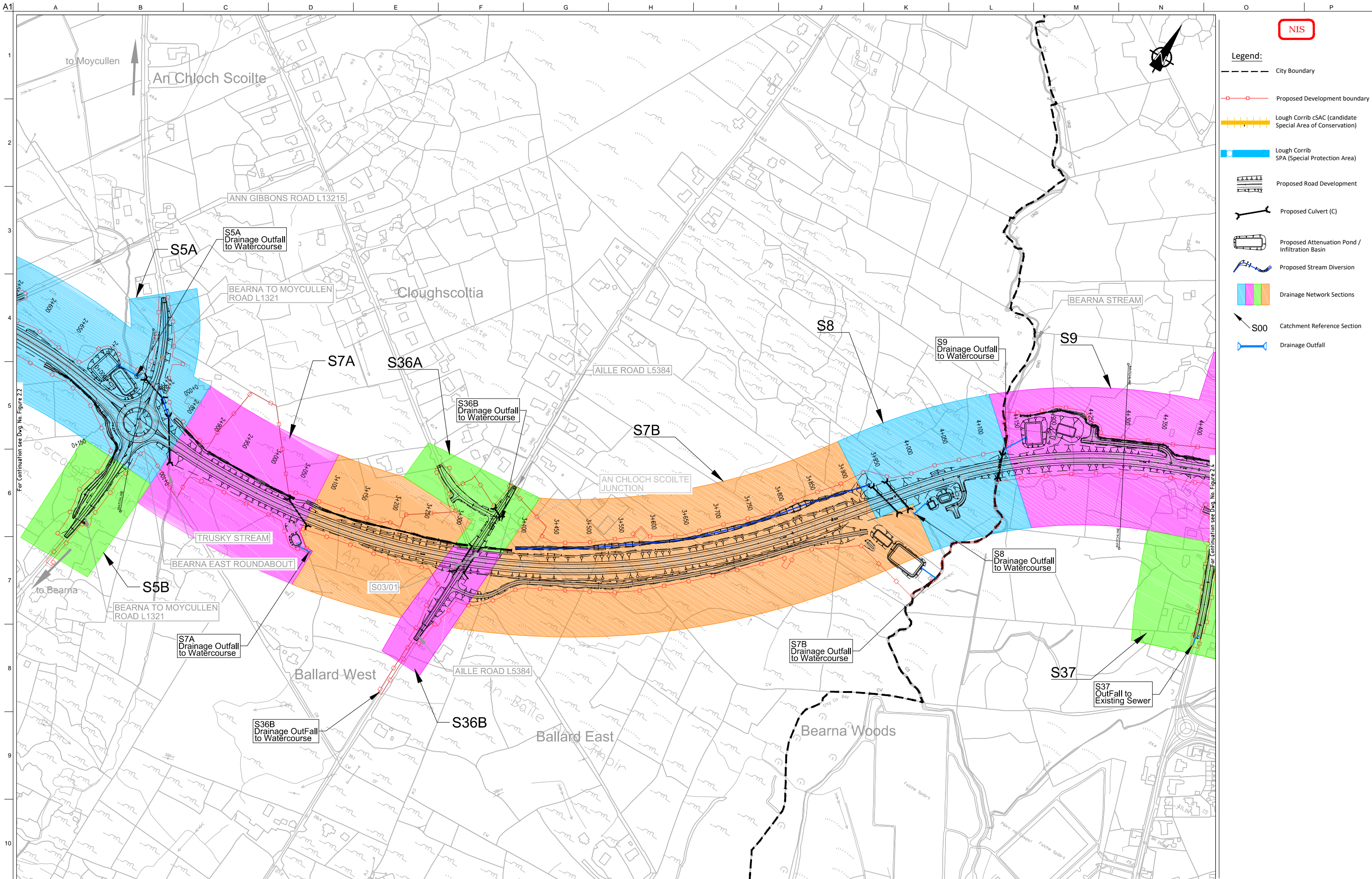

- Legend:**
- City Boundary
  - Proposed Development boundary
  - Lough Corrib cSAC (candidate Special Area of Conservation)
  - Lough Corrib SPA (Special Protection Area)
  - Proposed Road Development
  - Proposed Culvert (C)
  - Proposed Attenuation Pond / Infiltration Basin
  - Proposed Stream Diversion
  - Drainage Network Sections
  - S00 Catchment Reference Section
  - Drainage Outfall

Son áiríamh tá sonraíocht Shuirbhíreacht Orlándaí Éireann arna aistriú go dtí Ceardúnas OSI Uimh. 2010/18CCMA/Comhairle Contae na Gaillimhe. Sáráilom aistriú go dtí na ceardúnas na cíoscheart Shuirbhíreacht Orlándaí Éireann agus Rialtas na hÉireann. © Suirbhíreacht Orlándaí Éireann, 2010.

© Suirbhíreacht Orlándaí Éireann. Gach ceart ar chosaint. Uimhir cheadúnas 2010/18CCMA/Comhairle Contae na Gaillimhe.

Includes Ordnance Survey Ireland data reproduced under OSI Licence number 2010/18CCMA/Galway County Council. Unauthorised reproduction infringes Ordnance Survey Ireland and Government of Ireland copyright. © Ordnance Survey Ireland, 2010.

© Ordnance Survey Ireland. All rights reserved. Licence number 2010/18CCMA/Galway County Council.

**Clients**

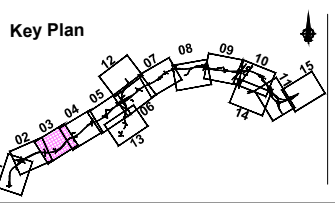

**Consultant**

Corporate House  
City East Business Park  
Ballybrit, Galway, Ireland.

Tel +353 (0)91 460675  
www.N6GalwayCity.ie  
www.arup.ie

**Job Title**  
N6 Galway City Ring Road

**Scale**  
1:5000 @ A3

**Date:**  
September 2018

Issue	Date	By	Chkd	Appd
I3	28/09/2018	KJ	MH	EMC
I2	29/09/2017	AG	MH	EMC
I1	23/06/2017	AG	MH	EMC

**Drawing Title**  
Proposed Road Development Plan Layout and Drainage Network References  
Sheet 3 of 15

**Drawing Status**  
For Information

**Job No**  
233985

**Drawing No**  
Figure 2.3

**Issue**  
I3



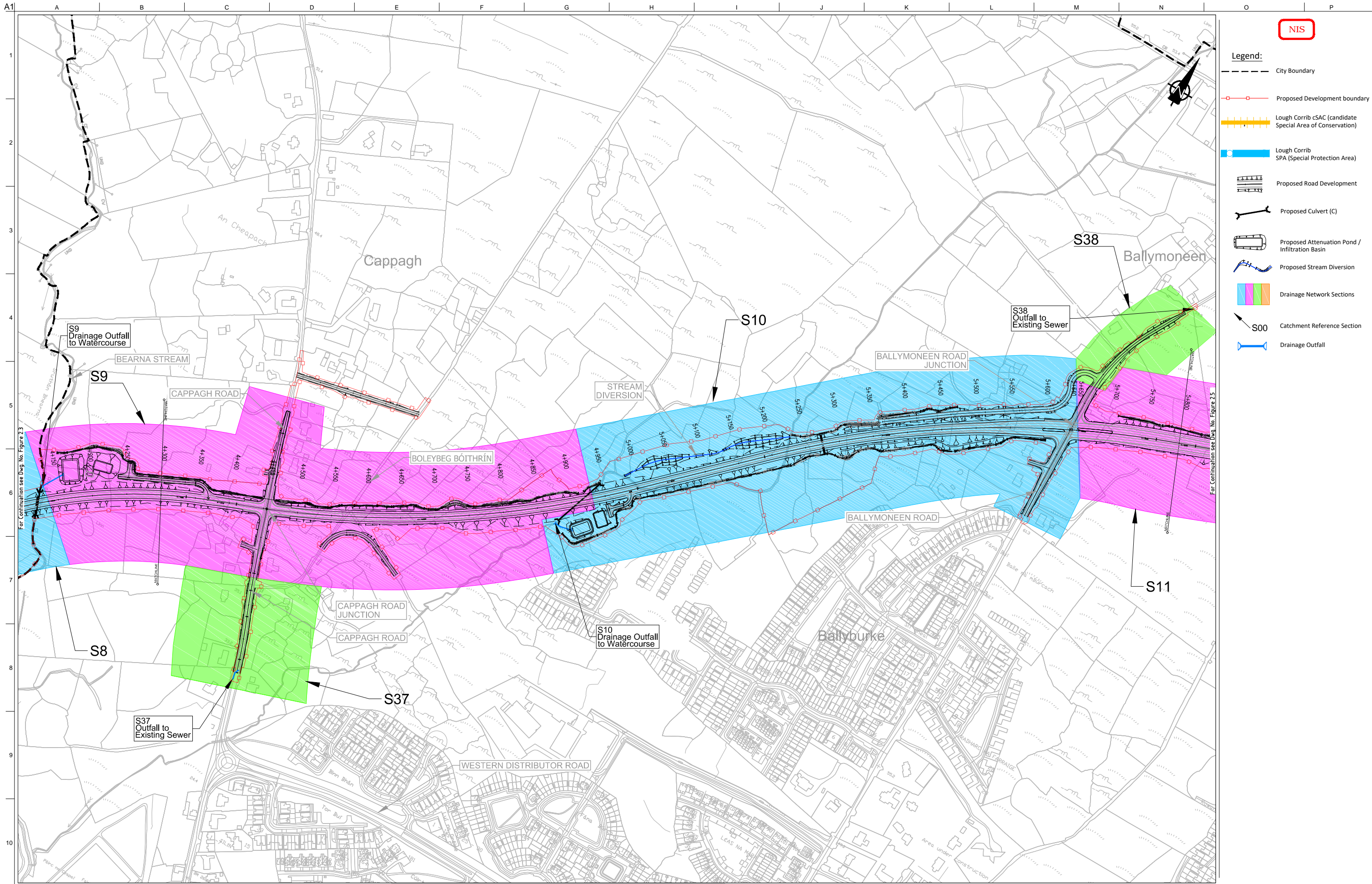

- Legend:**
- City Boundary
  - Proposed Development boundary
  - Lough Corrib cSAC (candidate Special Area of Conservation)
  - Lough Corrib SPA (Special Protection Area)
  - Proposed Road Development
  - Proposed Culvert (C)
  - Proposed Attenuation Pond / Infiltration Basin
  - Proposed Stream Diversion
  - Drainage Network Sections
  - S00 Catchment Reference Section
  - Drainage Outfall

Son áiríamh tá sonraíochtaí Shuirbhíreacha Orlándaís Éireann arna aistriú go dtí físeán OSI Uimh. 2010/18CCMA/Comhairle Contae na Gaillimhe. Sáráilom aistriú go dtí na h-áiríamh na h-Éireann. © Suirbhíreacha Orlándaís Éireann, 2010.

© Suirbhíreacha Orlándaís Éireann. Gach ceart ar chosaint. Uimhir cheadainis 2010/18CCMA/Comhairle Contae na Gaillimhe.

Includes Ordnance Survey Ireland data reproduced under OSI Licence number 2010/18CCMA/Galway County Council. Unauthorised reproduction infringes Ordnance Survey Ireland and Government of Ireland copyright. © Ordnance Survey Ireland, 2010.

© Ordnance Survey Ireland. All rights reserved. Licence number 2010/18CCMA/Galway County Council.

Clients

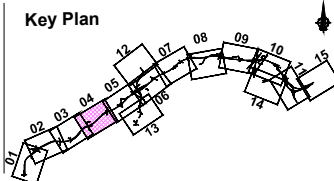

Consultant

Corporate House  
City East Business Park  
Ballybrit, Galway, Ireland.

Tel +353 (0)91 460675  
www.N6GalwayCity.ie  
www.arup.ie

Job Title  
**N6 Galway City Ring Road**

Scale  
1:5000 @ A3

Date:  
September 2018

Issue	Date	By	Chkd	Appd
I3	28/09/2018	KJ	MH	EMC
I2	29/09/2017	AG	MH	EMC
I1	23/06/2017	AG	MH	EMC

Drawing Title  
**Proposed Road Development Plan Layout and Drainage Network References**

Sheet 4 of 15

Drawing Status  
**For Information**

Job No  
**233985**

Drawing No  
**Figure 2.4**

Issue  
**13**



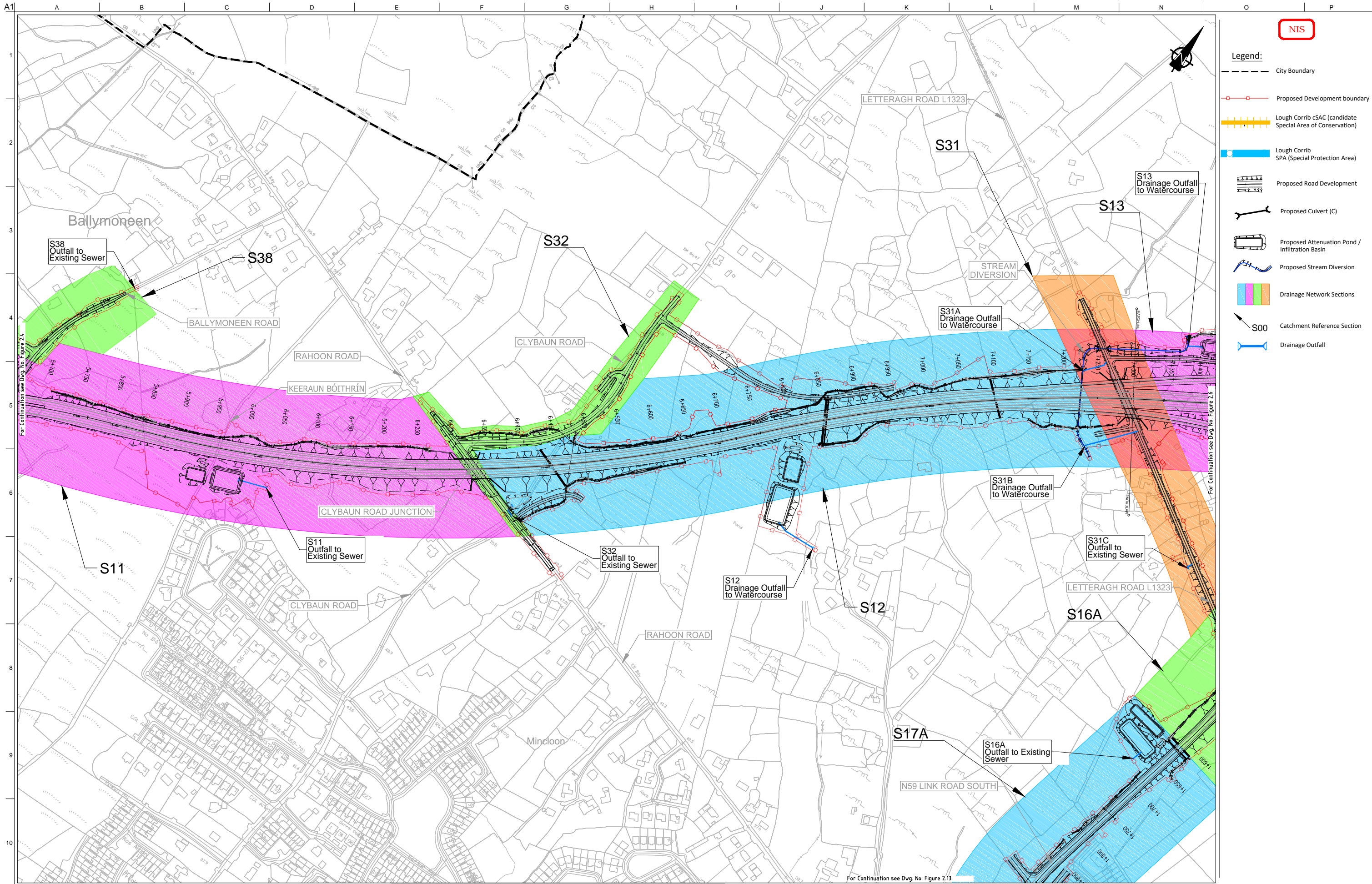

- Legend:**
- NIS
  - City Boundary
  - Proposed Development boundary
  - Lough Corrib cSAC (candidate Special Area of Conservation)
  - Lough Corrib SPA (Special Protection Area)
  - Proposed Road Development
  - Proposed Culvert (C)
  - Proposed Attenuation Pond / Infiltration Basin
  - Proposed Stream Diversion
  - Drainage Network Sections
  - S00 Catchment Reference Section
  - Drainage Outfall

Sun áiríonn tá sonraíocht Shairbhíreacht Orlándaí Éireann arna aistriú go dtí físeán OSI Uimh. 2010/18CCMA/Comhairle Contae na Gaillimhe. Sáráilonn aistriú go dtí na h-áiríocháin cíoscheart Shairbhíreacht Orlándaí Éireann agus Rialtas na hÉireann. © Sairbhíreacht Orlándaí Éireann, 2010.

© Sairbhíreacht Orlándaí Éireann. Gach ceart ar chosaint. Uimhir cheadainis 2010/18CCMA/Comhairle Contae na Gaillimhe.

Includes Ordnance Survey Ireland data reproduced under OSI Licence number 2010/18CCMA/Galway County Council. Unauthorised reproduction infringes Ordnance Survey Ireland and Government of Ireland copyright. © Ordnance Survey Ireland, 2010.

© Ordnance Survey Ireland. All rights reserved. Licence number 2010/18CCMA/Galway County Council.

Clients

**Comhairle Contae na Gaillimhe**  
Galway County Council

**N6**  
Galway City Transport Project

**An Roinn Iompair**  
Turasóireachta agus Spóirt

**TIIP**  
Transport Infrastructure Ireland

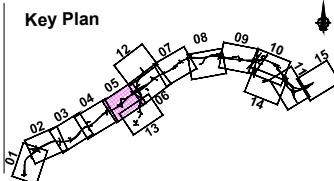

Consultant

**ARUP**

Corporate House  
City East Business Park  
Ballybrit, Galway, Ireland.

Tel +353 (0)91 460675  
www.N6GalwayCity.ie  
www.arup.ie

Job Title  
**N6 Galway City Ring Road**

Scale  
1:5000 @ A3

Date:  
September 2018

Issue	Date	By	Chkd	Appd
I3	28/09/2018	KJ	MH	EMC
I2	29/09/2017	AG	MH	EMC
I1	23/06/2017	AG	MH	EMC

Drawing Title  
**Proposed Road Development Plan Layout and Drainage Network References**

Sheet 5 of 15

Drawing Status  
**For Information**

Job No  
**233985**

Drawing No  
**Figure 2.5**

Issue  
**13**



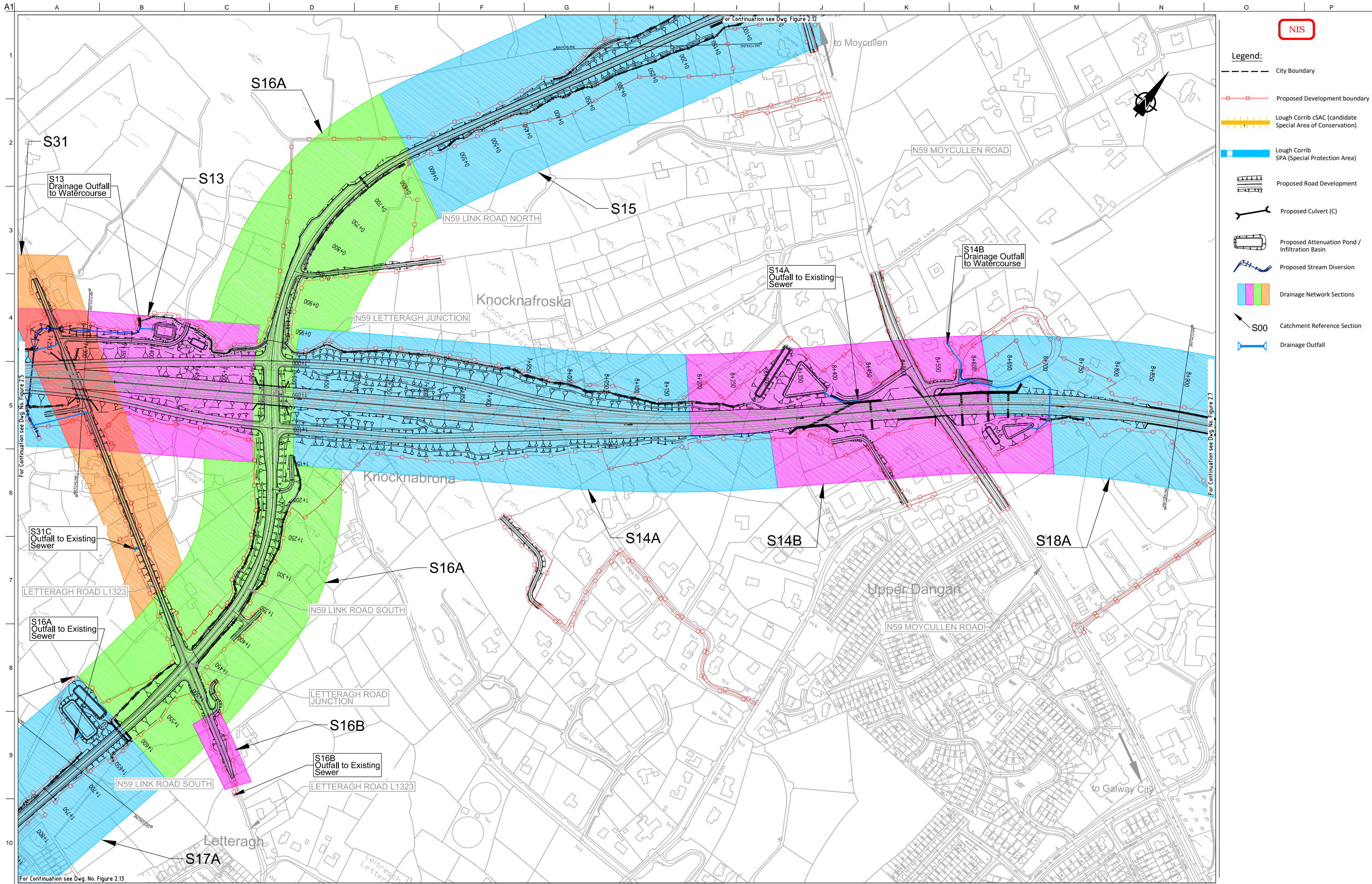

San áiríúmh tá sonraíocht Shuirbhíreacht Orlándaí Éireann arna aistriú go dtí Ceolúnas OSI Uimh. 2010/18CCMA/Comhairle Contae na Gaillimhe. Sáráilom aistriú go dtí neamhdáraithe cóipeacht Shuirbhíreacht Orlándaí Éireann agus Rialtas na hÉireann. © Suirbhíreacht Orlándaí Éireann, 2010.

© Suirbhíreacht Orlándaí Éireann. Gach ceart ar chosaint.  
Uimhir cheadúnais 2010/18CCMA/Comhairle Contae na Gaillimhe.

Includes Ordnance Survey Ireland data reproduced under OSI Licence number 2010/18CCMA/Galway County Council.  
Unauthorised reproduction infringes Ordnance Survey Ireland and Government of Ireland copyright. © Ordnance Survey Ireland, 2010.

© Ordnance Survey Ireland. All rights reserved. Licence number 2010/18CCMA/Galway County Council.

Do not scale  
J:\233000\233985-004\_ Internal\4-02 Drawings\4-02-6 Environmental\6.24 NIS\Figure 2.1 to 2.15\_13.dwg

Clients

Comhairle Chontae na Gaillimhe  
Galway County Council

An Roinn Iompair  
Turasóireachta agus Spóirt  
Department of Transport, Tourism and Sport

TII  
Transport Infrastructure Ireland

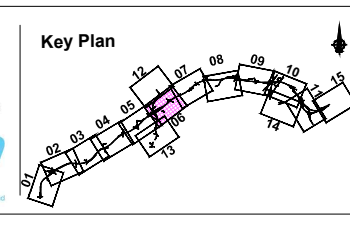

Consultant

Corporate House  
City East Business Park  
Ballybrit, Galway, Ireland.

Tel +353 (0)91 460675  
www.N6GalwayCity.ie  
www.arup.ie

Job Title  
N6 Galway City Ring Road  
and Drainage Network

Scale  
1:5000 @ A3

Date:  
September 2018

I3	28/09/2018	KJ	MH	EMC
I2	29/09/2017	AG	MH	EMC
I1	23/06/2017	AG	MH	EMC
Issue	Date	By	Chkd	Appd

Drawing Title  
Proposed Road Development Plan Layout  
and Drainage Network References  
Sheet 6 of 15

Drawing Status  
**For Information**

Job No  
**233985**

Drawing No  
**Figure 2.6**

Issue  
**13**



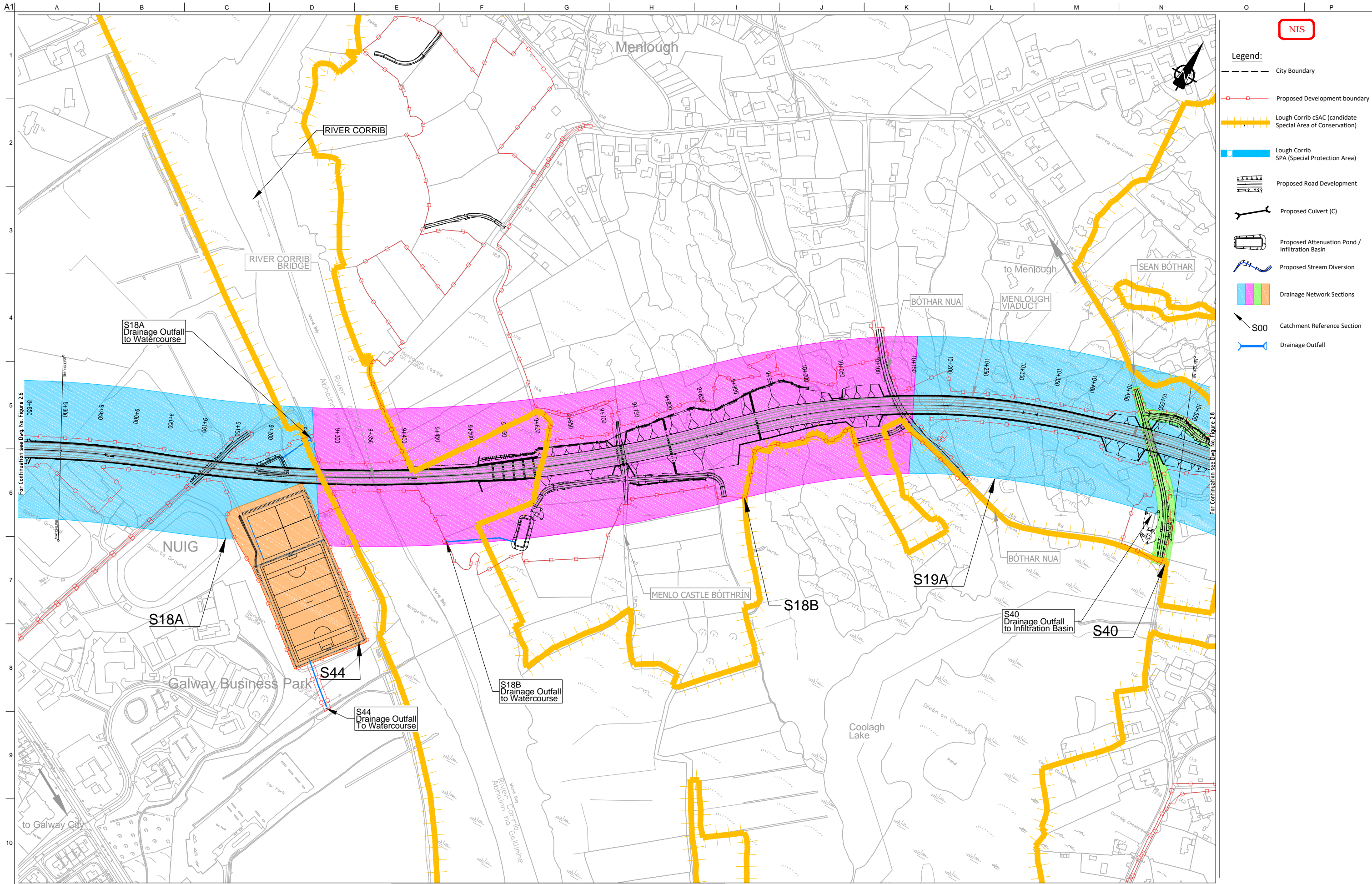

- Legend:**
- City Boundary
  - Proposed Development boundary
  - Lough Corrib cSAC (candidate Special Area of Conservation)
  - Lough Corrib SPA (Special Protection Area)
  - Proposed Road Development
  - Proposed Culvert (C)
  - Proposed Attenuation Pond / Infiltration Basin
  - Proposed Stream Diversion
  - Drainage Network Sections
  - S00 Catchment Reference Section
  - Drainage Outfall

San áiríamh tá sonraíocht Shairbhíreachtú Orlándaís Éireann arna aistriúgeadh fíor Cheadúnas OSI Uimh. 2010/18CCMA/Comhairle Contae na Gaillimhe. Sárúilom aistriúgeadh namhádaraithe cóipeacht Shairbhíreachtú Orlándaís Éireann agus Rialtas na hÉireann. © Sairbhíreachtú Orlándaís Éireann, 2010.

© Sairbhíreachtú Orlándaís Éireann. Gach ceart ar chosaint. Uimhir cheadúnais 2010/18CCMA/Comhairle Contae na Gaillimhe.

Includes Ordnance Survey Ireland data reproduced under OSI Licence number 2010/18CCMA/Galway County Council. Unauthorised reproduction infringes Ordnance Survey Ireland and Government of Ireland copyright. © Ordnance Survey Ireland, 2010.

© Ordnance Survey Ireland. All rights reserved. Licence number 2010/18CCMA/Galway County Council.

Clients

Comhairle Chontae na Gaillimhe  
Galway County Council

Galway City Transport Project

An Roinn Iompair  
Turasóireachta agus Spóirt

TIIP  
Bonnagarraíompaí Éireann

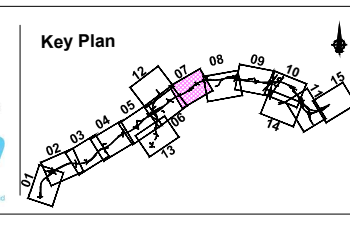

Consultant

**ARUP**

Corporate House  
City East Business Park  
Ballybrit, Galway, Ireland.

Tel +353 (0)91 460675  
www.N6GalwayCity.ie  
www.arup.ie

Job Title  
**N6 Galway City Ring Road**

Scale  
1:5000 @ A3

Date  
September 2018

Issue	Date	By	Chkd	Appd
I3	28/09/2018	KJ	MH	EMC
I2	29/09/2017	AG	MH	EMC
I1	23/06/2017	AG	MH	EMC

Drawing Title  
Proposed Road Development Plan Layout and Drainage Network References  
Sheet 7 of 15

Drawing Status  
**For Information**

Job No  
**233985**

Drawing No  
**Figure 2.7**

Issue  
**13**



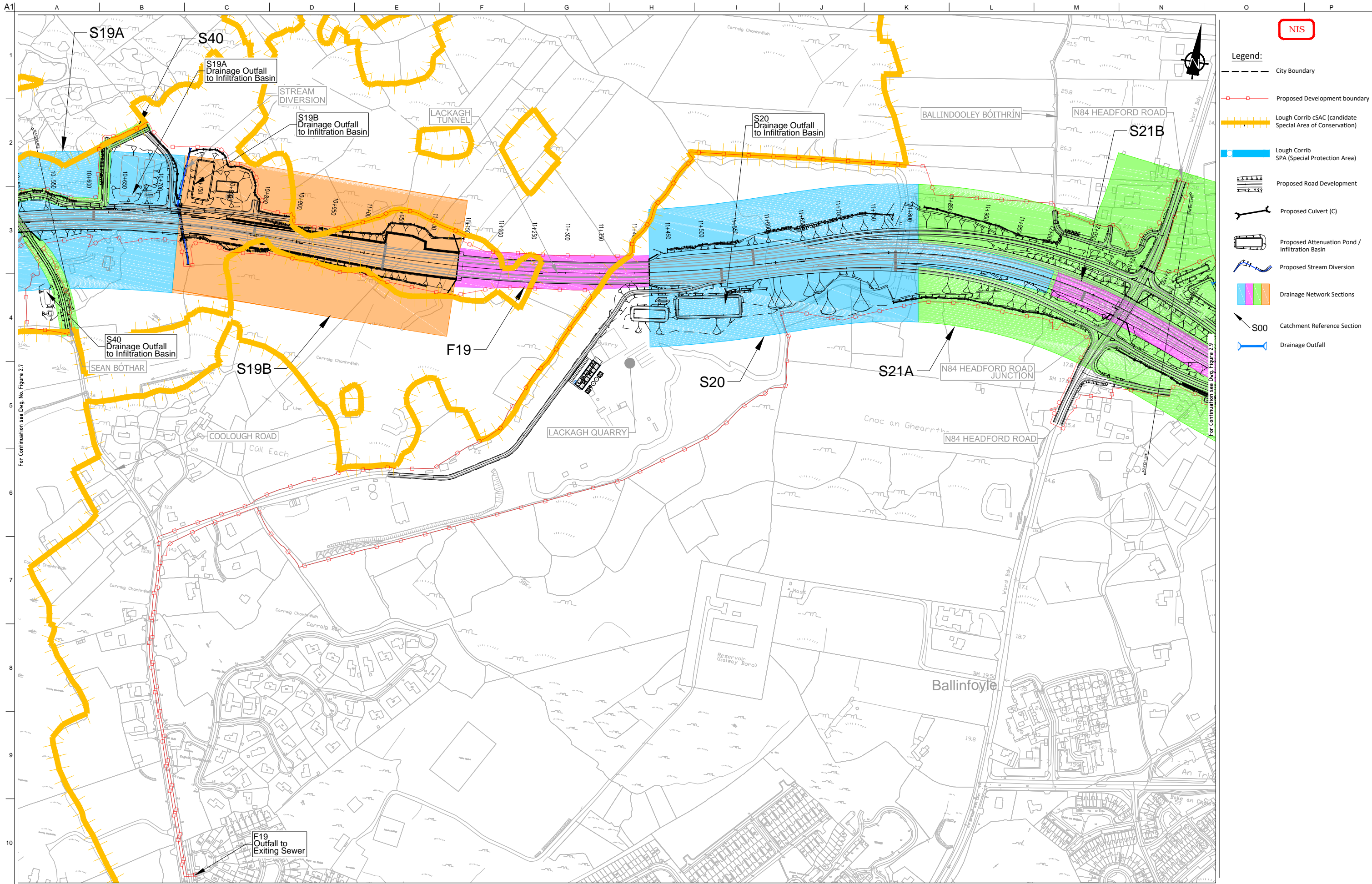

- Legend:**
- NIS
  - City Boundary
  - Proposed Development boundary
  - Lough Corrib cSAC (candidate Special Area of Conservation)
  - Lough Corrib SPA (Special Protection Area)
  - Proposed Road Development
  - Proposed Culvert (C)
  - Proposed Attenuation Pond / Infiltration Basin
  - Proposed Stream Diversion
  - Drainage Network Sections
  - S00 Catchment Reference Section
  - Drainage Outfall

Son áiríamh tá sonraíocht Shairbhéireacht Ordois Éireann arna aistriú go dtailéad físeán OSI Uimh. 2010/18CCMA/Comhairle Contae na Gaillimhe. Sáráilom aistriú go dtailéad físeán cópcheart Shairbhéireacht Ordois Éireann agus Rialtas na hÉireann. © Sairbhéireacht Ordois Éireann, 2010.

© Sairbhéireacht Ordois Éireann. Gach ceart ar chosaint. Uimhir cheadainn 2010/18CCMA/Comhairle Contae na Gaillimhe.

Includes Ordnance Survey Ireland data reproduced under OSI Licence number 2010/18CCMA/Galway County Council. Unauthorised reproduction infringes Ordnance Survey Ireland and Government of Ireland copyright. © Ordnance Survey Ireland, 2010.

© Ordnance Survey Ireland. All rights reserved. Licence number 2010/18CCMA/Galway County Council.

Clients

**Comhairle Chontae na Gaillimhe**  
Galway County Council

**N6**  
Galway City Transport Project

**An Roinn Iompair**  
Turasóireacht agus Spóirt

**TIIP**  
Bonneagar Tompar Éireann

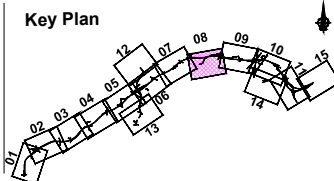

Consultant

**ARUP**

Corporate House  
City East Business Park  
Ballybrit, Galway, Ireland.

Tel +353 (0)91 460675  
www.N6GalwayCity.ie  
www.arup.ie

Job Title  
**N6 Galway City Ring Road**

Scale  
1:5000 @ A3

Date:  
September 2018

Issue	Date	By	Chkd	Appd
I3	28/09/2018	KJ	MH	EMC
I2	29/09/2017	AG	MH	EMC
I1	23/06/2017	AG	MH	EMC

Drawing Title  
**Proposed Road Development Plan Layout and Drainage Network References**  
Sheet 8 of 15

Drawing Status  
**For Information**

Job No  
**233985**

Drawing No  
**Figure 2.8**

Issue  
**I3**



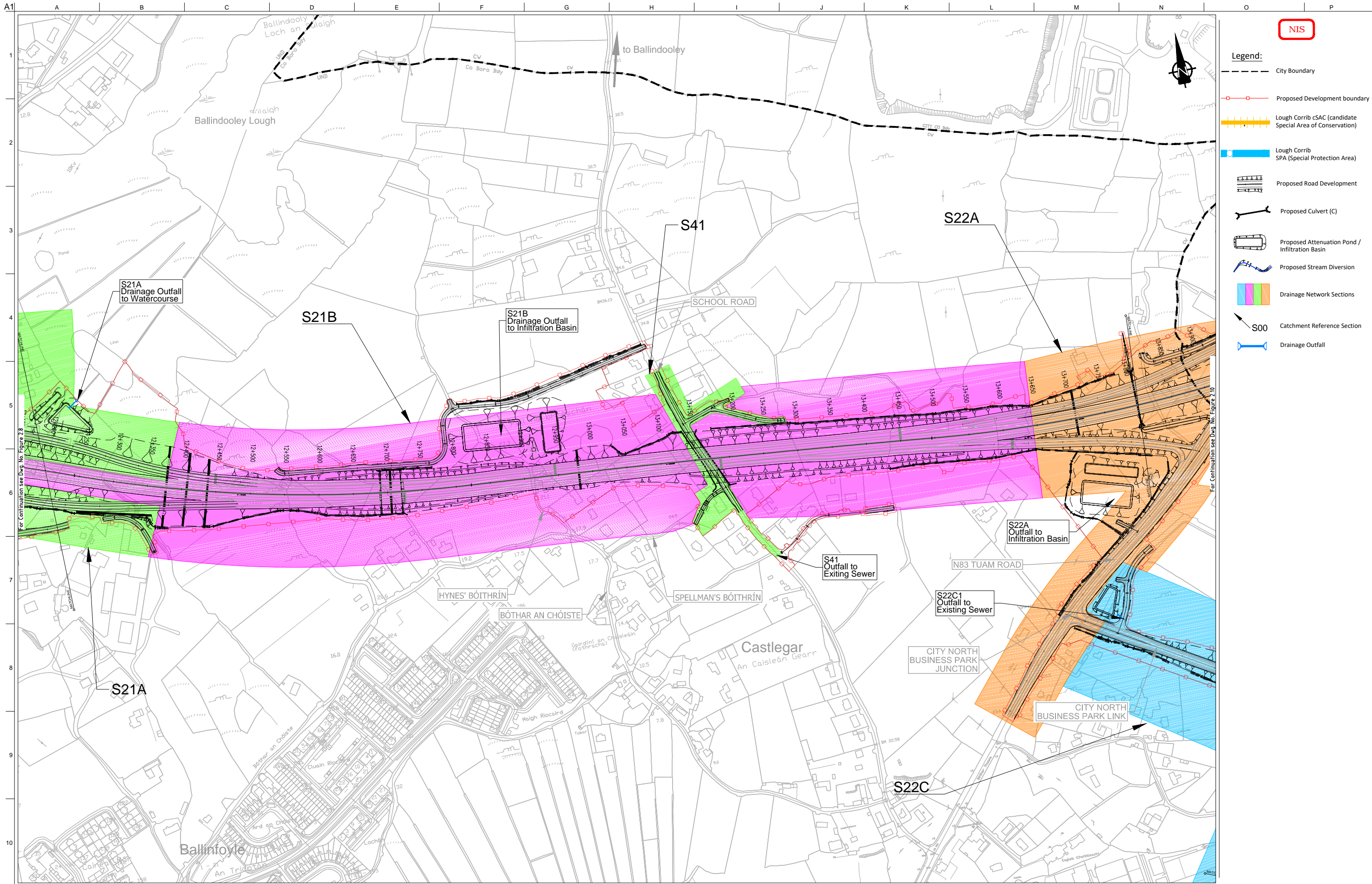

Sun áiríonn sé sonraíocht Shairbhíreacht Orlándaí Éireann arna aistriú go dtí Ceardúnas OSI Uimh. 2010/18CCMA/Comhairle Contae na Gaillimhe. Sáráilonn aistriú go dtí ceardúnas na cíoscheart Shairbhíreacht Orlándaí Éireann agus Rialtas na hÉireann. © Sairbhíreacht Orlándaí Éireann, 2010.

© Sairbhíreacht Orlándaí Éireann. Gach ceart ar chosaint. Uimhir cheadúnais 2010/18CCMA/Comhairle Contae na Gaillimhe.

Includes Ordnance Survey Ireland data reproduced under OSI Licence number 2010/18CCMA/Galway County Council. Unauthorised reproduction infringes Ordnance Survey Ireland and Government of Ireland copyright. © Ordnance Survey Ireland, 2010.

© Ordnance Survey Ireland. All rights reserved. Licence number 2010/18CCMA/Galway County Council.

Clients

**Comhairle Chontae na Gaillimhe**  
Galway County Council

**N6**  
Galway City Transport Project

**An Roinn Iompair**  
Turasóireacht agus Spóirt

**TIIP**  
Bonnagar Impair Éireann

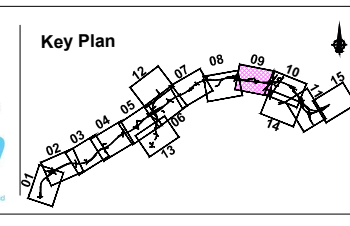

Consultant

**ARUP**

Corporate House  
City East Business Park  
Ballybrit, Galway, Ireland.

Tel +353 (0)91 460675  
www.N6GalwayCity.ie  
www.arup.ie

Job Title  
**N6 Galway City Ring Road**

Scale  
1:5000 @ A3

Date  
September 2018

Issue	Date	By	Chkd	Appd
I3	28/09/2018	KJ	MH	EMC
I2	29/09/2017	AG	MH	EMC
I1	23/06/2017	AG	MH	EMC

Drawing Title  
Proposed Road Development Plan Layout and Drainage Network References  
Sheet 9 of 15

Drawing Status  
**For Information**

Job No  
**233985**

Drawing No  
**Figure 2.9**

Issue  
**13**



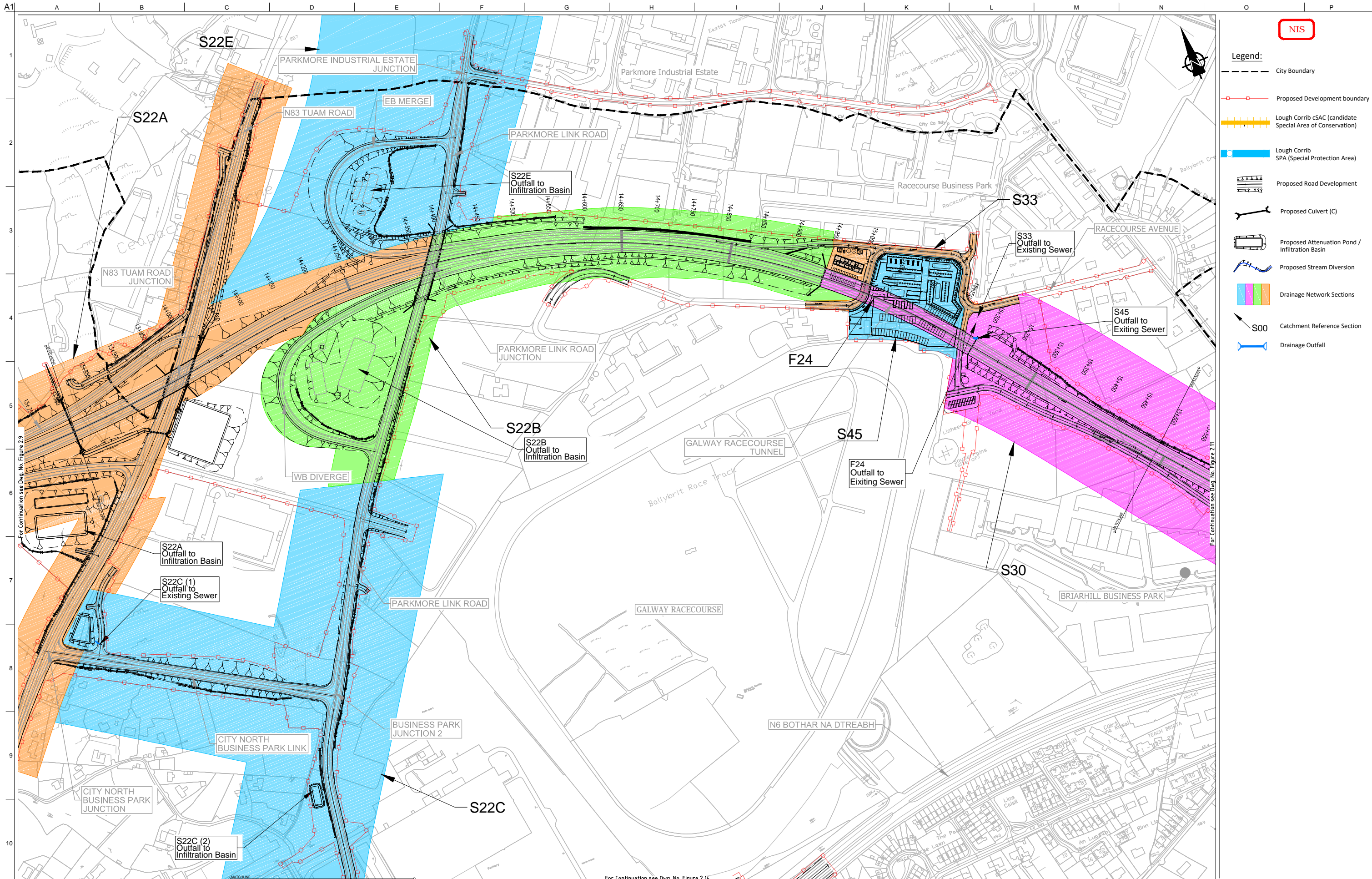

- Legend:**
- NIS
  - City Boundary
  - Proposed Development boundary
  - Lough Corrib cSAC (candidate Special Area of Conservation)
  - Lough Corrib SPA (Special Protection Area)
  - Proposed Road Development
  - Proposed Culvert (C)
  - Proposed Attenuation Pond / Infiltration Basin
  - Proposed Stream Diversion
  - Drainage Network Sections
  - S00 Catchment Reference Section
  - Drainage Outfall

Sun áirímh tá sonraíocht Shuirbhíreacht Orlándaí Éireann arna aistriú go dtí fíor Cheadúnas OSI Uimh. 2010/18CCMA/Comhairle Contae na Gaillimhe. Sáráilom aistriú go dtí na h-áirímh námhádaraithe cóipeacht Shuirbhíreacht Orlándaí Éireann agus Rialtas na hÉireann. © Suirbhíreacht Orlándaí Éireann, 2010.

© Suirbhíreacht Orlándaí Éireann. Gach ceart ar chosaint. Uimhir cheadúnais 2010/18CCMA/Comhairle Contae na Gaillimhe.

Includes Ordnance Survey Ireland data reproduced under OSI Licence number 2010/18CCMA/Galway County Council. Unauthorised reproduction infringes Ordnance Survey Ireland and Government of Ireland copyright. © Ordnance Survey Ireland, 2010.

© Ordnance Survey Ireland. All rights reserved. Licence number 2010/18CCMA/Galway County Council.

Clients

**Comhairle Chontae na Gaillimhe**  
Galway County Council

**N6**  
Galway City Transport Project

**An Roinn Iompair**  
Turasóireachta agus Spóirt  
Department of Transport, Tourism and Sport

**TII**  
Transport Infrastructure Ireland

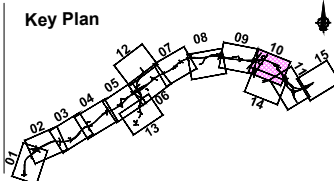

Consultant

**ARUP**

Corporate House  
City East Business Park  
Ballybrit, Galway, Ireland.

Tel +353 (0)91 460675  
www.N6GalwayCity.ie  
www.arup.ie

Job Title  
**N6 Galway City Ring Road**

Scale  
1:5000 @ A3

Date:  
September 2018

I3	28/09/2018	KJ	MH	EMC
I2	29/09/2017	AG	MH	EMC
I1	23/06/2017	AG	MH	EMC
Issue	Date	By	Chkd	Appd

Drawing Title  
Proposed Road Development Plan Layout

Sheet 10 of 15

Drawing Status  
**For Information**

Job No  
**233985**

Drawing No  
**Figure 2.10**

Issue  
**13**



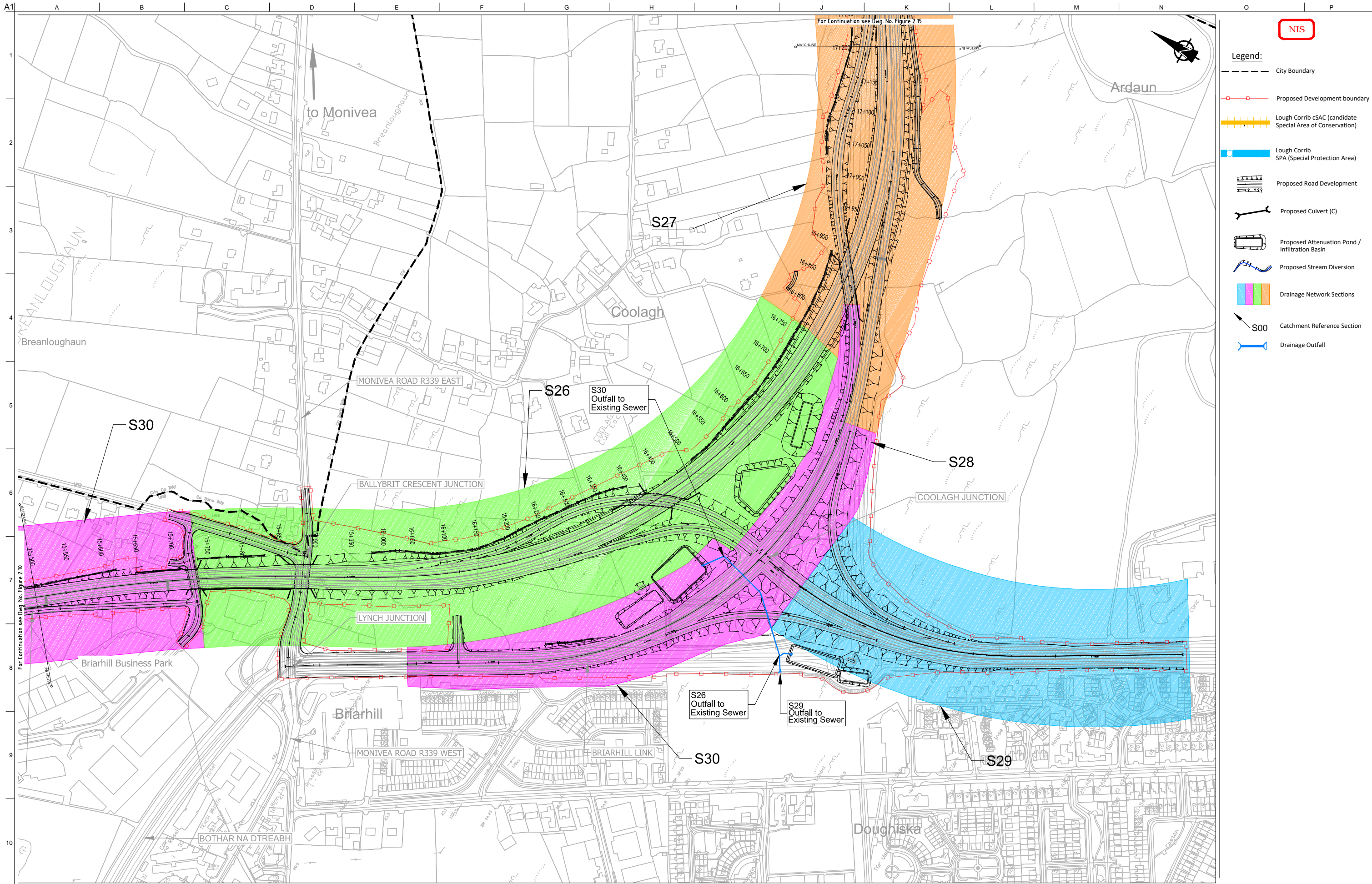

San áiríúmh tá sonraíocht Shairbhíreacha Orlándaís Éireann arna aistriúgeadh fíor Cheadúnas OSI Umh. 2010/18CCMA/Comhairle Contae na Gaillimhe. Sáráilom aistriúgeadh namhádaraithe cóipeacht Shairbhíreacha Orlándaís Éireann agus Rialtas na hÉireann. © Sairbhíreacha Orlándaís Éireann, 2010.

© Sairbhíreacha Orlándaís Éireann. Gach ceart ar chosaint. Umhír cheadúnas 2010/18CCMA/Comhairle Contae na Gaillimhe.

Includes Ordnance Survey Ireland data reproduced under OSI Licence number 2010/18CCMA/Galway County Council. Unauthorised reproduction infringes Ordnance Survey Ireland and Government of Ireland copyright. © Ordnance Survey Ireland, 2010.

© Ordnance Survey Ireland. All rights reserved. Licence number 2010/18CCMA/Galway County Council.

Clients

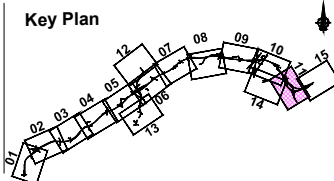

Consultant

Corporate House  
City East Business Park  
Ballybrit, Galway, Ireland.

Tel +353 (0)91 460675  
www.NGalwayCity.ie  
www.arup.ie

Job Title  
**N6 Galway City Ring Road**

Scale  
1:5000 @ A3

Date:  
September 2018

Issue	Date	By	Chkd	Appd
I3	28/09/2018	KJ	MH	EMC
I2	29/09/2017	AG	MH	EMC
I1	23/06/2017	AG	MH	EMC

Drawing Title  
Proposed Road Development Plan Layout and Drainage Network References  
Sheet 11 of 15

Drawing Status  
**For Information**

Job No  
**233985**

Drawing No  
**Figure 2.11**

Issue  
**I3**



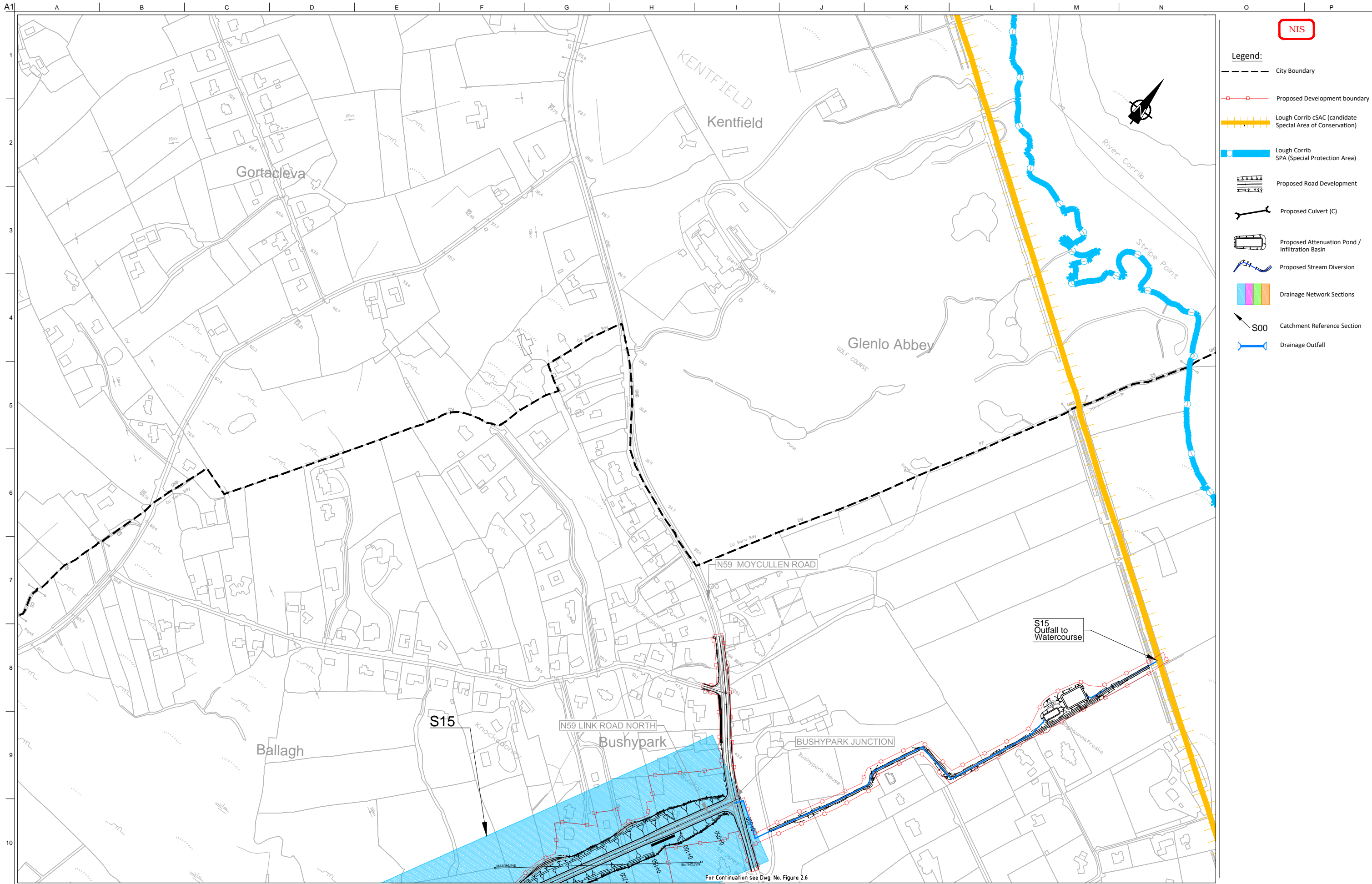

- Legend:**
- City Boundary
  - Proposed Development boundary
  - Lough Corrib cSAC (candidate Special Area of Conservation)
  - Lough Corrib SPA (Special Protection Area)
  - Proposed Road Development
  - Proposed Culvert (C)
  - Proposed Attenuation Pond / Infiltration Basin
  - Proposed Stream Diversion
  - Drainage Network Sections
  - S00 Catchment Reference Section
  - Drainage Outfall

San áiríúmh tá sonraíocht Shuirbhíreacht Orlándaís Éireann arna áitirgeadh fíor Cheadúnas OSI Uimh. 2010/18CCMA/Comhairle Contae na Gaillimhe. Sáráilom áitirgeadh neamhdáraithe cóipeacht Shuirbhíreacht Orlándaís Éireann agus Rialtas na hÉireann. © Suirbhíreacht Orlándaís Éireann, 2010.

© Suirbhíreacht Orlándaís Éireann. Gach ceart ar chosaint. Uimhir cheadúnais 2010/18CCMA/Comhairle Contae na Gaillimhe.

Includes Ordnance Survey Ireland data reproduced under OSI Licence number 2010/18CCMA/Galway County Council. Unauthorised reproduction infringes Ordnance Survey Ireland and Government of Ireland copyright. © Ordnance Survey Ireland, 2010.

© Ordnance Survey Ireland. All rights reserved. Licence number 2010/18CCMA/Galway County Council.

Clients

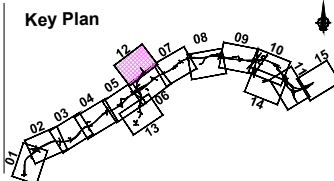

Consultant

Corporate House  
City East Business Park  
Ballybrit, Galway, Ireland.

Tel +353 (0)91 460675  
www.N6GalwayCity.ie  
www.arup.ie

Job Title  
**N6 Galway City Ring Road**

Scale  
1:5000 @ A3

Date  
September 2018

Issue	Date	By	Chkd	Appd
I3	28/09/2018	KJ	MH	EMC
I2	29/09/2017	AG	MH	EMC
I1	23/06/2017	AG	MH	EMC

Drawing Title  
**Proposed Road Development Plan Layout and Drainage Network References**  
Sheet 12 of 15

Drawing Status  
**For Information**

Job No  
**233985**

Drawing No  
**Figure 2.12**

Issue  
**13**



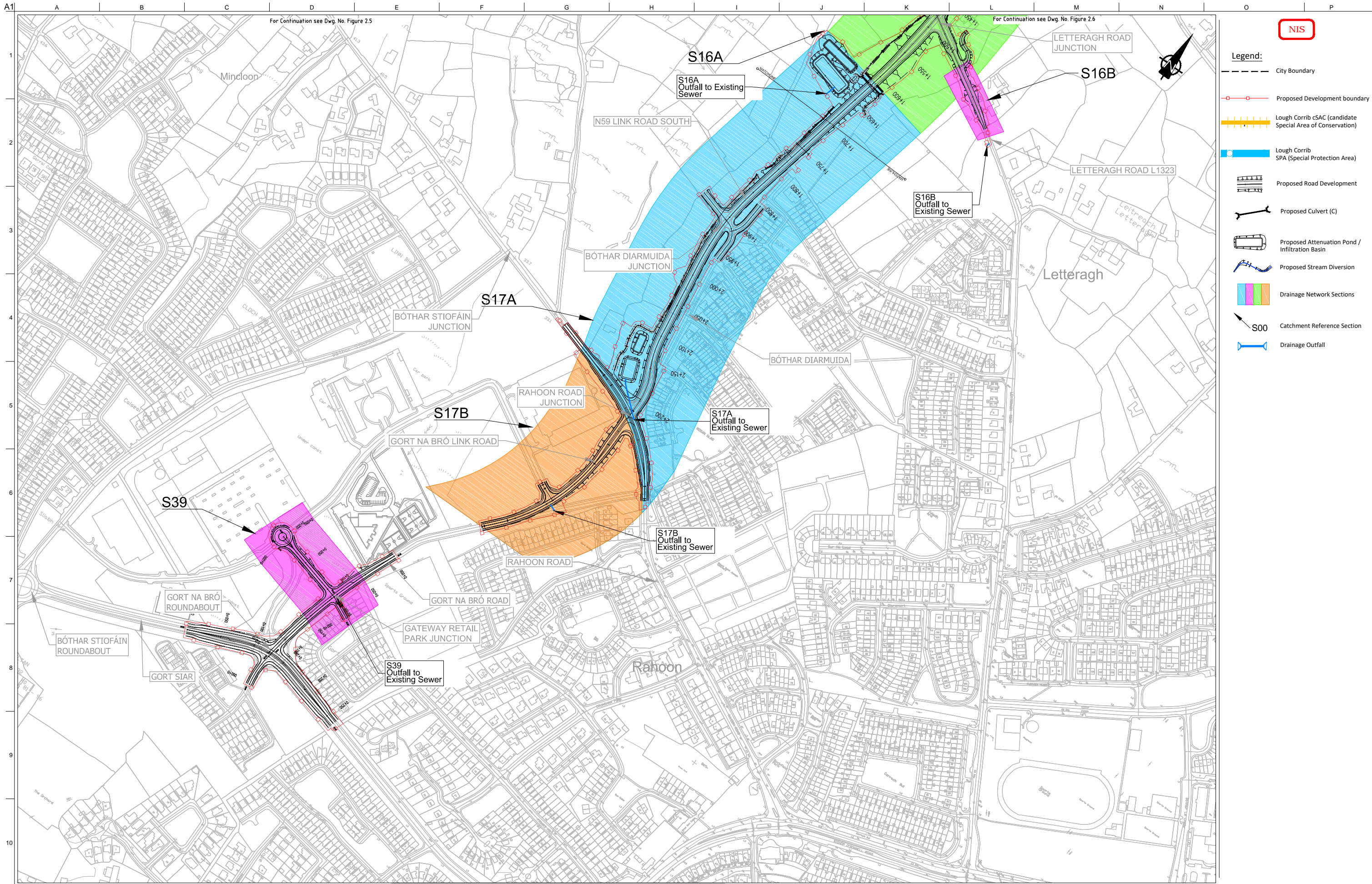

- Legend:**
- City Boundary
  - Proposed Development boundary
  - Lough Corrib cSAC (candidate Special Area of Conservation)
  - Lough Corrib SPA (Special Protection Area)
  - Proposed Road Development
  - Proposed Culvert (C)
  - Proposed Attenuation Pond / Infiltration Basin
  - Proposed Stream Diversion
  - Drainage Network Sections
  - S00 Catchment Reference Section
  - Drainage Outfall

San áiríonn tá sonraíocht Shairbhíreacht Orlánáís Éireann arna aistriú go dtí físeán Ceidhúnas OSI Uimh. 2010/18CCMA/Comhairle Contae na Gaillimhe. Sáráilonn aistriú go dtí neamhádaraithe cóipeacht Shairbhíreacht Orlánáís Éireann agus Rialtas na hÉireann. © Sairbhíreacht Orlánáís Éireann, 2010.

© Sairbhíreacht Orlánáís Éireann. Gach ceart ar chosaint. Uimhir cheadainis 2010/18CCMA/Comhairle Contae na Gaillimhe.

Includes Ordnance Survey Ireland data reproduced under OSI Licence number 2010/18CCMA/Galway County Council. Unauthorised reproduction infringes Ordnance Survey Ireland and Government of Ireland copyright. © Ordnance Survey Ireland, 2010.

© Ordnance Survey Ireland. All rights reserved. Licence number 2010/18CCMA/Galway County Council.

Clients

Comhairle Contae na Gaillimhe  
Galway County Council

N6 Galway City Transport Project

An Roinn Iompair Turasóireachta agus Spóirt

TIIP

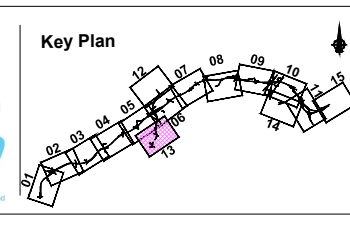

Consultant

**ARUP**

Corporate House  
City East Business Park  
Ballybrit, Galway, Ireland.

Tel +353 (0)91 460675  
www.N6GalwayCity.ie  
www.arup.ie

Job Title  
**N6 Galway City Ring Road**

Scale  
1:5000 @ A3

Date:  
September 2018

Issue	Date	By	Chkd	Appd
I3	28/09/2018	KJ	MH	EMC
I2	29/09/2017	AG	MH	EMC
I1	23/06/2017	AG	MH	EMC

Drawing Title  
**Proposed Road Development Plan Layout and Drainage Network References**  
Sheet 13 of 15

Drawing Status  
**For Information**

Job No  
**233985**

Drawing No  
**Figure 2.13**

Issue  
**13**



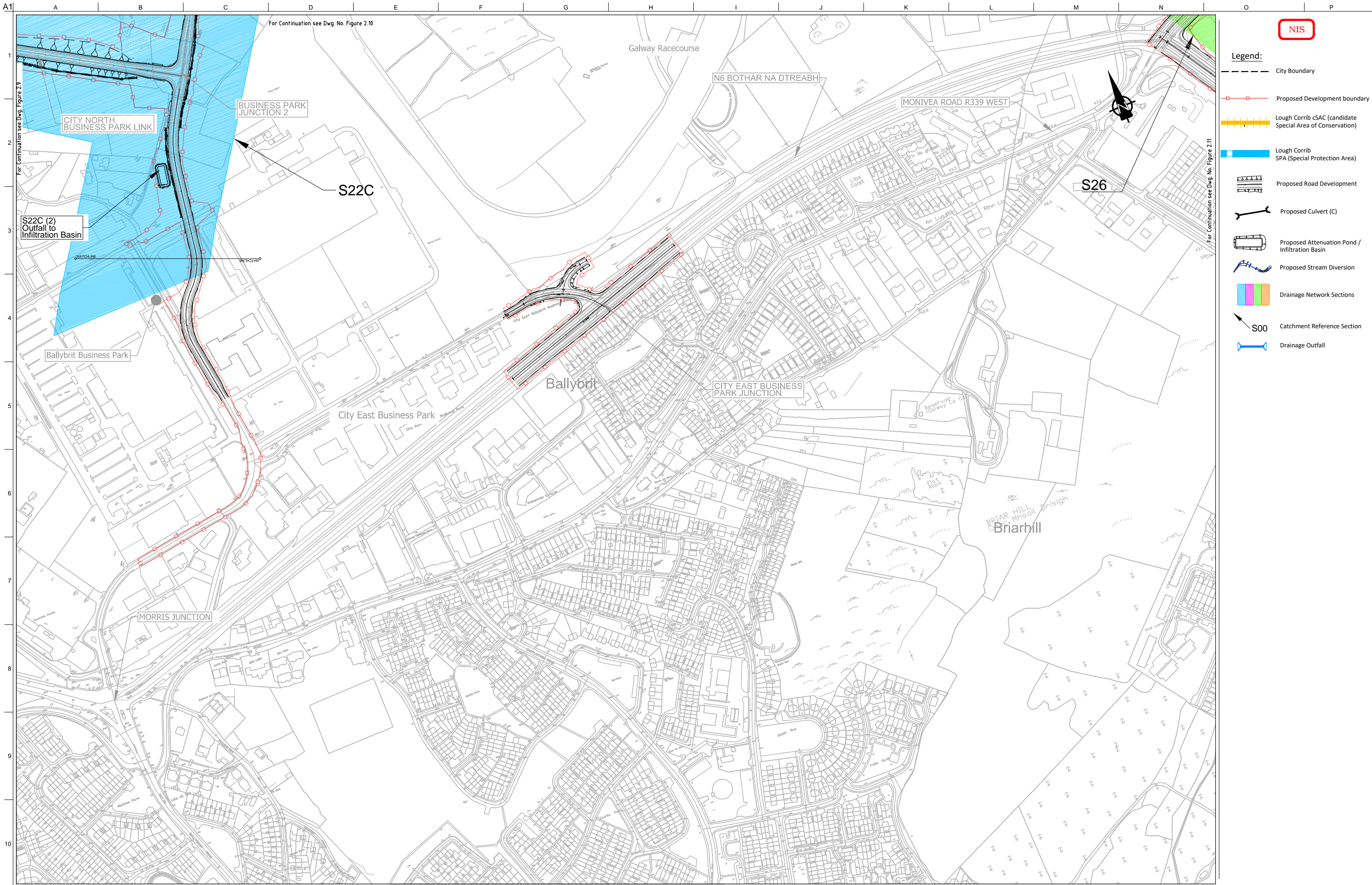

San áiríamh tá sonraíocht Shuirbhíreacht Orlándaís Éireann arna aistriú go dtailíú físeáil Cheadúnas OSI Uimh. 2010/18CCMA/Comhairle Contae na Gaillimhe. Sáráilom aistriú go dtailíú físeáil cheadúnas na císcheart Shuirbhíreacht Orlándaís Éireann agus Rialtas na hÉireann. © Suirbhíreacht Orlándaís Éireann, 2010.

© Suirbhíreacht Orlándaís Éireann. Gach ceart ar chosaint.  
Uimhir cheadúnais 2010/18CCMA/Comhairle Contae na Gaillimhe.

Includes Ordnance Survey Ireland data reproduced under OSI Licence number 2010/18CCMA/Galway County Council.  
Unauthorised reproduction infringes Ordnance Survey Ireland and Government of Ireland copyright. © Ordnance Survey Ireland, 2010.

© Ordnance Survey Ireland. All rights reserved. Licence number 2010/18CCMA/Galway County Council.

Clients

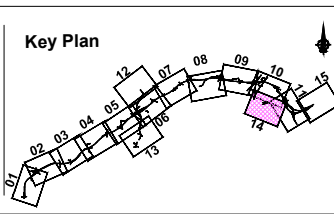

Consultant

Corporate House  
City East Business Park  
Ballybrit, Galway, Ireland.

Tel +353 (0)91 460675  
www.N6GalwayCity.ie  
www.arup.ie

Job Title  
**N6 Galway City Ring Road**

Scale  
1:5000 @ A3

Date:  
September 2018

Issue	Date	By	Chkd	Appd
I3	28/09/2018	KJ	MH	EMC
I2	29/09/2017	AG	MH	EMC
I1	23/06/2017	AG	MH	EMC

Drawing Title  
**Proposed Road Development Plan Layout and Drainage Network References**  
Sheet 14 of 15

Drawing Status  
**For Information**

Job No  
**233985**

Drawing No  
**Figure 2.14**

Issue  
**I3**



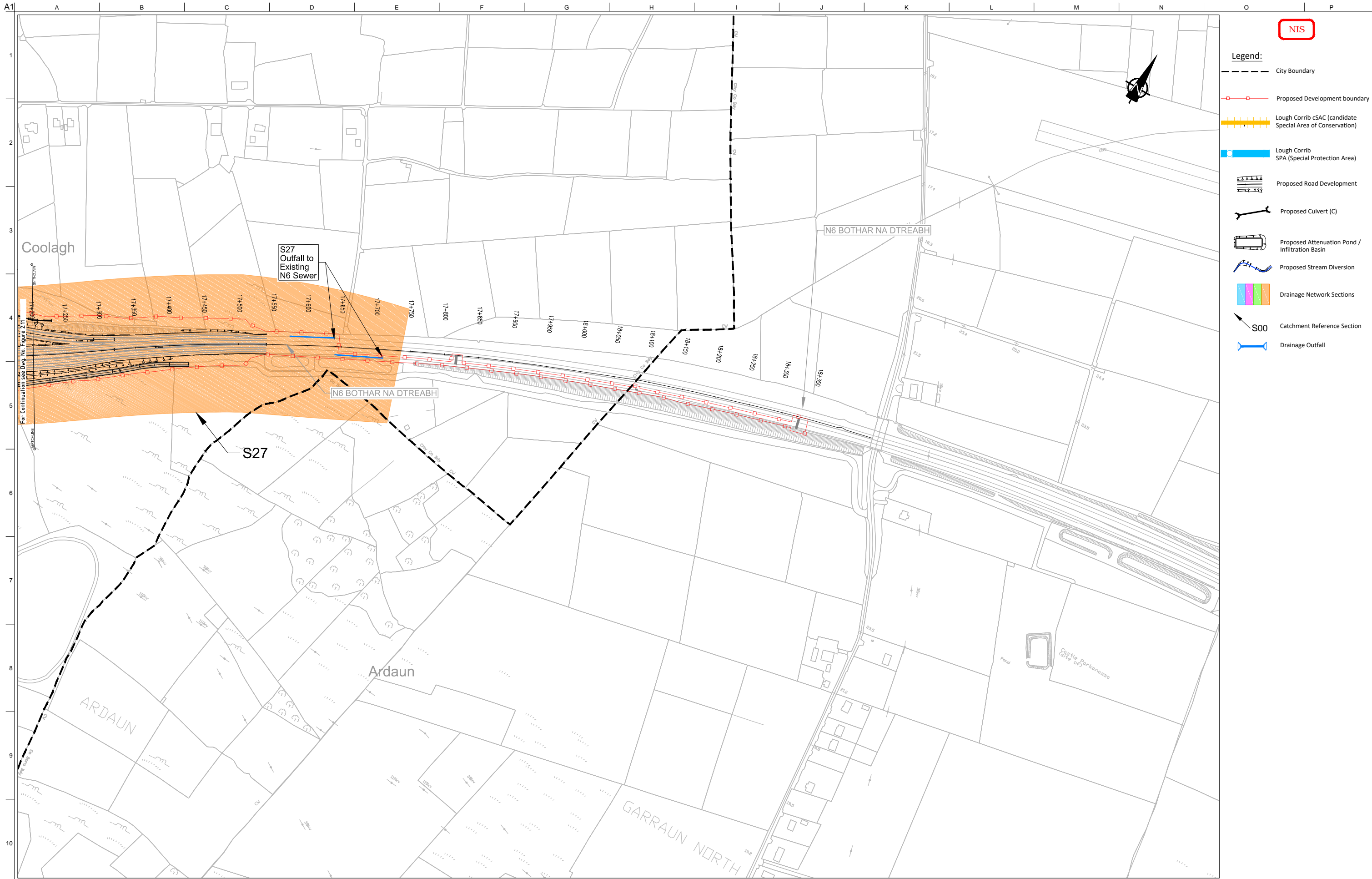

- Legend:**
- City Boundary
  - Proposed Development boundary
  - Lough Corrib cSAC (candidate Special Area of Conservation)
  - Lough Corrib SPA (Special Protection Area)
  - Proposed Road Development
  - Proposed Culvert (C)
  - Proposed Attenuation Pond / Infiltration Basin
  - Proposed Stream Diversion
  - Drainage Network Sections
  - S00 Catchment Reference Section
  - Drainage Outfall

Son áireamh tá sonraíocht Shuirbhíreacht Orlandáis Éireann arna aistriú go dtí físeán OSI Uimh. 2010/18CCMA/Comhairle Contae na Gaillimhe. Sáráilonn aistriú go dtí neamh-dáiríreacht cóipeacht Shuirbhíreacht Orlandáis Éireann agus Rialtas na hÉireann. © Suirbhíreacht Orlandáis Éireann, 2010.

© Suirbhíreacht Orlandáis Éireann. Gach ceart ar chosaint. Uimhir cheadainis 2010/18CCMA/Comhairle Contae na Gaillimhe.

Includes Ordnance Survey Ireland data reproduced under OSI Licence number 2010/18CCMA/Galway County Council. Unauthorised reproduction infringes Ordnance Survey Ireland and Government of Ireland copyright. © Ordnance Survey Ireland, 2010.

© Ordnance Survey Ireland. All rights reserved. Licence number 2010/18CCMA/Galway County Council.

Clients

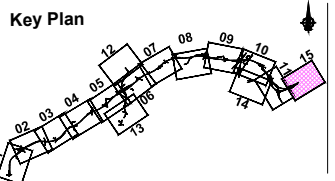

Consultant

Corporate House  
City East Business Park  
Ballybrit, Galway, Ireland.

Tel +353 (0)91 460675  
www.N6GalwayCity.ie  
www.arup.ie

Job Title  
**N6 Galway City Ring Road**

Scale  
1:5000 @ A3

Date:  
September 2018

Issue	Date	By	Chkd	Appd
I3	28/09/2018	KJ	MH	EMC
I2	29/09/2017	AG	MH	EMC
I1	23/06/2017	AG	MH	EMC

Drawing Title  
**Proposed Road Development Plan Layout and Drainage Network References**  
Sheet 15 of 15

Drawing Status  
**For Information**

Job No  
**233985**

Drawing No  
**Figure 2.15**

Issue  
**I3**